



# MIRAMAR CULTURAL CENTER TECHNICAL SPECIFICATIONS



2400 CIVIC CENTER PLACE  
MIRAMAR, FLORIDA 33025  
(954) 602-4500

[www.miramarculturalcenter.org](http://www.miramarculturalcenter.org)

# TABLE OF CONTENTS

	Page
<b>GENERAL INFORMATION</b>	
Directory .....	3
Directions and Map .....	4
Floor Plan of Facility .....	5
Seating Diagram .....	6
<b>THEATER INFORMATION</b>	
General Theater Information .....	7
Stage Information .....	7
Sound and Communication Systems .....	8
Stage Lighting and Power Distribution .....	9
Dimmer Location .....	11
Lineset Schedule .....	12
House Rep Lighting Plot .....	13
<b>LOCAL AREA SERVICES.....</b>	<b>14</b>



## MIRAMAR CULTURAL CENTER | ARTSPARK DIRECTORY

**Main Address**                      2400 Civic Center Place Miramar, Florida 33025  
**Website**                              [www.miramarculturalcenter.org](http://www.miramarculturalcenter.org)

<b>Main Phone Number</b>	<b>954-602-4500</b>
<b>Sales</b>	<b>954-602-4509</b>
<b>Production</b>	<b>954-602-4979</b>
<b>Event Services</b>	<b>954-602-4514</b>
<b>Box Office</b>	<b>954-602-4530</b>
<b>Food &amp; Beverage/Banquet Hall</b>	<b>954-602-4535</b>
<b>Security Office</b>	<b>954-602-4540</b>
<b>Ansin Family Art Gallery</b>	<b>954-602-4525</b>

## **DIRECTIONS AND MAP**

The Miramar Cultural Center | ArtsPark is a major component of the Miramar Town Center, a dynamic mixed-use complex of civic, retail and residential development. This 49,000 square-foot cultural facility has a 776 seat state-of-the-art auditorium, banquet/kitchen facilities, fine art gallery, classrooms, dance studio, and botanical garden to create a cultural focal point for the City of Miramar. Free parking is available directly across from the center and there is also a covered parking garage adjacent to the center.

From Interstate-95:

Take I-95 exit Hallandale Beach Blvd. Go West on Hallandale Beach Blvd. (Hallandale Beach Blvd. changes to Miramar Parkway at State Rd. 7/441). Continue going West to Red Road. Make right on Red Road heading North. After you pass Hiatus Road, the building is on the right.

From Interstate-75:

Take I-75, exit Miramar Parkway East.

Go East to Red Road. Make left on Red Road going North. After you pass Hiatus Road, the building is on the right.

From Florida Turnpike Homestead Extension:

Exit Homestead Extension on Red Road and head North. After you pass Hiatus Road, the building is on the right.

To Backstage Parking Lot:

From Red Road, turn onto Civic Center Place and make immediate left at the guard gate.



**1<sup>st</sup> Floor Floorplan of MIRAMAR CULTURAL CENTER | ARTSPARK FACILITY**

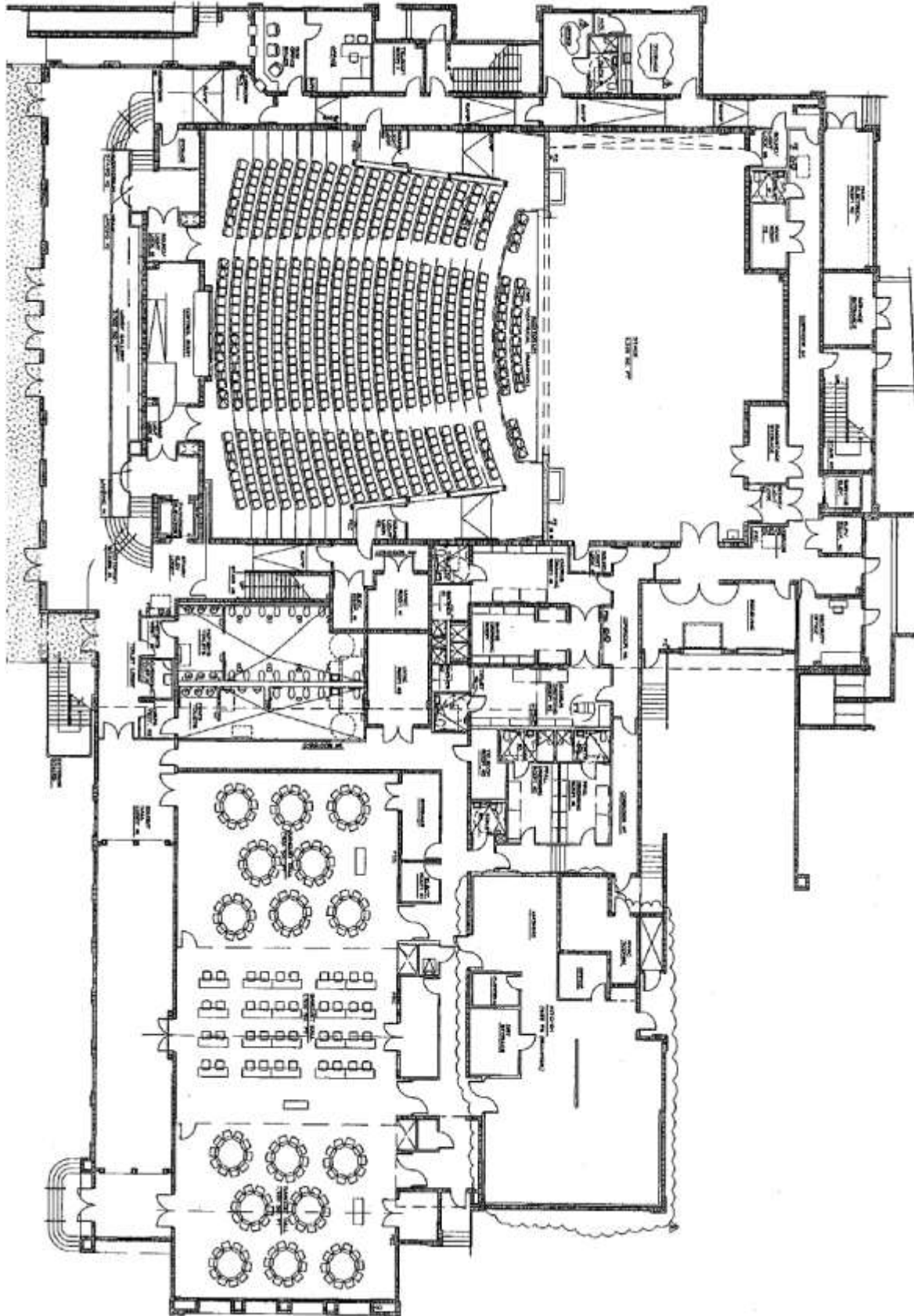



Max Capacity = 807 (803 with killed seats) • Min Capacity = 790

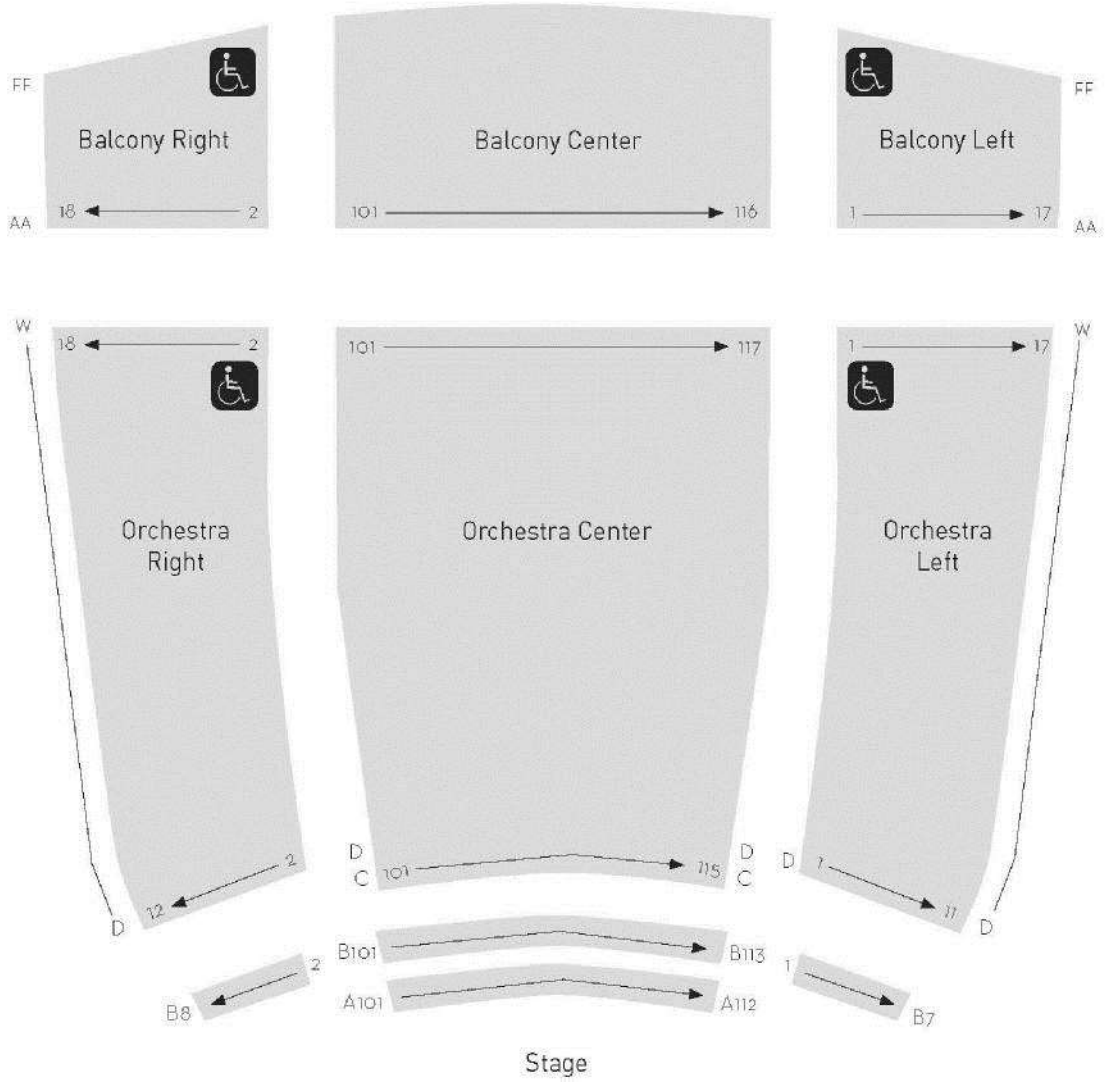

2400 Civic Center Place • Miramar, Florida 33025 • 954.602.4500 • www.MiramarCulturalCenter.org

# TECHNICAL INFORMATION

## HOUSE AND SEATING

**Capacity: 776 including optional handicapped seating. Orchestra: 581. Balcony: 195.**

Orchestra level has 4 entrances, 2 house rear right and left, 2 house front right and left.

Upper orchestra seating has 4 aisles; lower orchestra seating has 2 aisles.

Balcony has 2 entrances: both located balcony rear. Balcony seating has 4 aisles.

## LOADING ENTRANCE / DOCK

Loading dock located on the west side of the building, truck level, stage left. There are 2 bays, 1 bay equipped with a dock leveler plate. Loading dock can accommodate 2- 53' trailers at one time, although 1 at a time recommended because access requires reversing around a 90 degree turn.

Loading dock doors: 2 @ 8'-10" wide x 9'-11" high. Dock level: 3'-11" above pavement.

Loading dock storage: 29'-10" long x 12'-3" wide x 12'-5" high.

**House provides 1 (one) Genie AWP-30S personnel lift.**

**4400 lb. capacity pallet jack available for use.**

*\*\*Ramps or forklifts are not provided.*

## BACKSTAGE

Wardrobe room is equipped with washer/dryer, sink. Room is accessed by freight elevator to 2<sup>nd</sup> floor.

## DRESSING ROOMS

**1** principal dressing room: with a shower and a private toilet. Capacity: 8

**2** chorus dressing rooms: each with a shower and toilet. Capacity: 12 each

**1** swing dressing room: shares showers and toilets with chorus dressing rooms. Capacity: 12

Direct access from DSL entrance. USR access via backstage hallway.

## CARPENTRY/PROPS/DECK

### STAGE FLOOR

Stage floor is masonite on pine tongue and groove on plywood sub-flooring on resiliently mounted wood sleepers.

Floor is painted low luster black.

### STAGE DIMENSIONS

- Grid height 54'-3"
- Proscenium height 24'-0"
- Proscenium width 45'-0"
- Depth of stage (max) 53'-3"
- Back wall to curtain line 40'-0"
- Orchestra Shell storage to curtain line 35'-0"
- Plasterline to DS edge of Apron 3'-0"
- Plasterline to DS edge of Orchestra Pit 11'-3"
- Width of Stage House (wall to wall) 77'-4"
- Width of Stage House (Center to SR rigging) 35'-8"
- Width of Stage House (Center to SR wall) 38'-8"
- Width of Stage House (Center to SL wall) 38'-8"

*\*When the Cyc is used as the backdrop, there is **NO** upstage crossover space.*

- Orchestra Pit: semi-circular in shape, on demountable platforms. Forestage can be configured as a stage extension, audience seating area or orchestra pit. There is no pit overhang. When pit is removed for orchestra, a removable audience safety wall is installed at the audience level. This does not affect the dimensions of the orchestra pit.

- Pit depth (max) 6'-10" Pit Floor below seating 3'-3.5"

- Pit width 47'-4" Pit capacity: 24 musicians.

### **OTHER DIMENSIONAL INFORMATION**

Curtain line to Control Booth 69'-4"

Curtain line to Projection Booth 75'-10"

Curtain line to Follow Spot Booth 81'-4"

Curtain line to FOH 2 Cove 50'-6"

Curtain line to Balcony Rail Center 47'-9"

Curtain line to Balcony Rail Ends 48'-6"

Curtain line to FOH 1 Cove 42'-2"

### **GRID AND ARBOR SYSTEM (See Line Set Schedule on page 12 for House hang positions)**

Linesets available (Single Purchase, Hand Operated): 32

Weight Capacity (per line set): 1300 lbs Total Weight available: 25,000 lbs

Batten Length: 55' schedule 40, 1.5" black pipe

Batten spacing 6" on center (some placed on 12" or 18" centers, see schedule below)

### **SOFT GOODS**

- 6 Black velour flat Borders 54'x10'
- 6 pair Black velour flat Legs 25'x12'
- 6 Black velour flat Tabs 25'x5'
- 1 Mid Stage Black (2 piece with center split, travelling, sewn flat) 55'x25'
- 1 white Cyclorama 56'x25'
- 1 black sharktooth scrim 55'x25' ○ 1 white sharktooth scrim 55'x25' ○ Grand
- Drape: Gold color (2 piece with center split, guillotine, 200% fullness) 55'x25'
- Full-stage covering Rosco dance floor available

### **RISERS/ORCHESTRA FURNITURE**

24 – Wenger Versalite 4'x8' Decks w/8", 16", and 24" Legs

2 – Wenger Versalite 2 step units (for use with 24" legs only)

\*Decks over 8" high require the use of safety railings, which are included.

50 – Wenger Nota Orchestra Chairs, 4 – Wenger Cello Chairs, 4 – Wenger Adjustable Height Musician Stools (27"-33"), 50 – Wenger Music Stands w/Lights, 2 tier Conductor Podium w/Conductor Stand

### **OTHER STAGE FURNITURE**

2 – Anchor Admiral Lecterns (46" x 25" x 20")

75 - Black Plastic Armless Chairs



## **SOUND AND COMMUNICATIONS SYSTEMS \*\***

Sound control is located in the sound booth at the back of the house, or at the rear of the orchestra level in the audience. Sound control in the audience position requires the removal of 16 seats; 8 in each of rows U and V, House Center Right.

**\*\* Any equipment not listed in the below spec can be provided from outside vendors at an additional cost.**

### **HOUSE MIX / PROCESSING**

Yamaha M7CL-48 Digital mixing console  
Tascam CD01UPRO CD/MP3 Disc Player  
HHB CDR882 Dual Deck CD Recorder/Player

### **MAIN PA SYSTEM**

#### Center Cabinets:

Top: EAW AX364 driven by QSC CX702 & QSC CX902  
Bottom: EAW AX296 driven by QSC CX702

#### Side Cabinets:

Top: 2 – EAW AX364 driven by QSC CX 702 & QSC CX 902  
Bottom: 2 – EAW AX 296 driven by QSC CX 702

#### Subwoofers:

2 each EAW SB180zP & EAW SB250zP driven by QSC CX1102

#### Front Fills:

6 – EAW SL12SE-JHA driven by QSC CX404

#### Under Balcony:

4 – EAW UB52 driven by QSC CX404

#### Over Balcony:

4 – EAW MK8196 driven by QSC CX404

### **MONITORS**

APB Dynasonics Spectra T48 (48 channel, 10 auxes, 8 VCA, 4 Matrices)

2 – Klark-Teknik DN360B 31-band House Equalizers

Ashly Protea System II 4.24G Equalizer w/Remote Control (8 channels)

2 – Klark-Teknik DN514 Plus 4-channel Gate

2 – Klark-Teknik DN504 Plus 4-channel Limiter

TC Electronics M3000 Reverb Processor

TC Electronics D2 Tap Delay

Yamaha SPX3000 Effects Processor

Tascam CD-A700 CD/Cassette Player

6 – EAW SM129zi wedges

4 – JBL VRX915M wedges

Snake run from DSL to FOH, 150' min. via underground 8" conduit

Monitors driven by 4 – QSC CX702 (8 monitor channels available)

Whirlwind 56 channel Mass Connector 2-way transformer isolated splitter

### **WIRELESS MICROPHONES**

4-Shure ULX Wireless Receivers (M1 frequencies)

4-Shure ULX1 Body packs w/4-Instrument cables

4- Shure UHF-R handhelds with Beta 87A capsules

4 –Shure ULX2 handhelds with BETA87C

10-Shure UR4D+ Dual Channel Diversity Receivers

16-Shure UR1M Micro-Bodypack Transmitter

15 - Samson SE10 Lavalieres Over-ear Condenser Mic

8- Countryman W6B6 lavalieres (Beige)

4-Sennheiser MKE2 Lavalieres (Black)

## **MICROPHONES& DIs**

6 – Shure SM57 dynamic	8 – Shure SM58 dynamic
2 – Shure SM58-S (Switched)	2 – Shure SM81 condenser
1 – Shure Beta91 condenser	1 – Shure Beta 52 dynamic
2 – Shure Beta87C condenser	2 – Audio Technica AT4033
1 – Sennheiser MD421	4 – ShureBeta56 Dynamic
4 – Crown PCC160	2 – Sennheiser E906
4 – Sennheiser E905	2 – Sennheiser E914
9 – Audio Technica U853R Choral Mics	2 – Countryman M4HP5RFEB 24” Gooseneck
4 – Whirlwind Hotbox DI	2 – BSS AR-133 DI
2 – Radial ProAV1 DI	2 – Radial ProAV2 DI
2 – Whirlwind PC-DI	

## **ACCESSORIES AND CABLING**

2 – Radial Engineering Pro-AV2 Stereo Dir. Input Boxes	
4 – Whirlwind Hot Box Direct Input Boxes	
2 – Whirlwind PC-DI Direct Input Boxes	
8 – Atlas Tall Round Base Boom Stands with 4 18” and 24” Booms	
2 – Whirlwind 12 channel, 50’ sub snakes (blue)	1 – Whirlwind 16 channel, 100’ sub snake (blk)
1 – Whirlwind 16 channel/4 returns 100’ snake (blk)	9 – K&M Tall Tripod Boom Stands
7 – K&M Short Tripod Boom Stands	2 – K&M Short Round Base Boom Stands
NL4 Speakon cable in lengths of 10’, 25’, 50’, and 100’	XLR cable in lengths of 15’, 20’, 25’ 50’, and 75’

## **POWER DISTRIBUTION FOR AUDIO SYSTEM**

1 - 100A 120/208VAC 3 Phase 4 Wire w/CamLok connections (Neutral and Ground Require Turnarounds)  
1 - 60A 120/208VAC 3 Phase 4 Wire w/CamLok connections (Neutral and Ground Require Turnarounds)

## **COMMUNICATION SYSTEM**

Clear-Com 4 channel with multiple operating positions

## **VIDEO/PROJECTION EQUIPMENT**

1–Sanyo PLC-WTC500L 5000 ANSI Lumen Projector  
3 – Toshiba LCD Video Projectors 3000 Lumens  
1– Stewart Firehawk LS 1.25 Gain Perforated 19’ x 35’ Movie Screen  
\*Cyclorama Drop & White Scrim can also be used as a projection surface.  
1 – 10 ½’ x 14’ Da-Lite Fast-Fold Screen with Stand and Dress Kit  
2 – 69” x 92” Da-Lite Picture King Tripod screens  
2 – 7’-6” x 10’ Da-Lite Fast Fold Screens  
1 – Kramer VP-44 HDMI Switcher/Scaler  
2 – Appo BDP-105 Blu-Ray Players  
1 – Geffen CAT5 HDMI Extender



**STAGE LIGHTING AND POWER DISTRIBUTION**

The Miramar Cultural Center is equipped with an effective general house “rep” plot. It comes focused and colored according to the plot. Any change or deviation from that plot during load-in must be restored during or immediately following the load out. Any deviation from the rep plot outside of focusing specials will incur labor charges to focus for the event **and** to restore to house plot focus.

**POWER DISTRIBUTION**

- FOH Catwalk - 100A 120/208VAC 3 Phase 4 Wire w/CamLok connections
- DSL – 100A 120/208VAC 3 Phase 4 Wire w/CamLok connections  
60A 120/208VAC 3 Phase 4 Wire w/CamLok connections
- \*\*DSL Disconnects designated for SOUND ONLY!*
- MSL – 100A 120/208VAC 3 Phase 4 Wire w/CamLok connections
- USL – 400A 120/208VAC 3 Phase 5 Wire w/CamLok connections
- USR - 100A 120/208VAC 3 Phase 4 Wire w/CamLok connections
- Loading Dock - 400A 120/208VAC 3 Phase 5 Wire w/CamLok connections
- Banquet Storage A - 100A 120/208VAC 3 Phase 4 Wire w/CamLok connections
- Banquet Storage B - 100A 120/208VAC 3 Phase 4 Wire w/CamLok connections  
200A 120/208VAC 3 Phase 4 Wire w/CamLok connections
- Banquet Storage C - 100A 120/208VAC 3 Phase 4 Wire w/CamLok connections
- 1 – Lex Products 60A Power Distribution Unit, 9 @ 20A duplex inputs w/50’ CamLoks  
*(All Disconnects Require Neutral and Ground Turnarounds)*

**CONTROL**

- ETC Ion 1024 with 30 faders
- Strand C21 Dimmer System
- 381 – 2.4kW Dimmers
- 24 – 2.4kW Non-Dim Circuits
- 3 – 60A Dimmers

**LIGHTING INVENTORY**

Most of the inventory is hanging in the House Repertory Plot – Any changes to the house repertory plot **MUST** be restored at the expense of the event.

- |  |   |
|--|---|
| 12 - ETC Source Four 14 degree ellipsoidal (HPL 750W)              | 24 - ETC Source Four 19 degree ellipsoidal (HPL 750W)         |
| 48 - ETC Source Four 26 degree ellipsoidal (HPL 750W)              | 48 - ETC Source Four 36 degree ellipsoidal (HPL 750W)         |
| 12 - ETC Source Four 50 degree ellipsoidal (HPL 750W)              | 12 - ETC Source Four Zoom 15-30 degree ellipsoidal (HPL 750W) |
| 12 - ETC Source Four Zoom 25-50 degree ellipsoidal (HPL 750W)      | 50 - ETC Source Four Par EA (HPL 750W)                        |
| 30 - L&E Mini-Strips 3 color 15 cell 150W ea. (EYC 75W MR-16 wide) | 12 - L&E Runt Cyc lights 3 color 3 cell (FCM 650W)            |
| 2 - Lycian SuperStar 1275 spotlights (1200W HMI)                   | 8 - Boom Bases with 12’ pipe                                  |
| 12 - Ocean Optics SeaChanger Extreme Green for Source Four         | 55’x25’ (3) color LED Star Curtain                            |

### **ACCESSORIES**

12 - Drop-in Iris assembly for Source Four  
48 - A-size pattern holders for Source Four  
24 - B-size pattern holders for Source Four  
72 - Top Hats for Source Four ERS  
36 - Top Hats for Source Four PAR  
24 - Half Hats for Source Four ERS

### **CABLING**

12 – 50’ Stage Pin (Orange)  
48 – 25’ Stage Pin (Purple)  
60 – 10’ Stage Pin (Green)  
72 – 5’ Stage Pin (Red)  
36 – Twofers

48 - Donuts for Source Four ERS

10 - Barndoors for Source Four PAR

48 - Swivel Cheesboroughs

6 - Scenery Bumpers 18”

24 - City Theatrical Safer Side Arms w/2 knuckles each

6 – Female Edison to Male Stage Pin Adaptors

6 – Female Stage Pin to Male Edison Adaptors

6 – 25’ DMX512 (Purple)

12 – 10’ DMX515 (Green)

24 – 5’ DMX512 (Red)

## DIMMER LOCATION INFORMATION

<b>Dimmer#</b>	<b>Location</b>	<b>Dimmer#</b>	<b>Location</b>
1-6	Follow Spot Booth	296	SL Drop Cable CC - 60A
7-12	Follow Spot Booth	297	SL Drop Cable DD - 60A
13-42	FOH 1 Catwalk	298-303	DSL Pin Rail
43-60	FOH 2 Catwalk	304-309	MSL Pin Rail
61-84	Balcony Rail	310-315	USL Pin Rail
85-90	HR Far Box Boom	316-321	DSR Pin Rail
91-96	HR Far Box Boom	322-327	MSR Pin Rail
97-102	HL Far Box Boom	328-333	USR Pin Rail
103-108	HL Far Box Boom	334-339	DSL Wall Box
109-114	HR Near Box Boom	340-345	DSR Wall Box
115-120	HR Near Box Boom	346-351	USL Wall Box
121-126	HL Near Box Boom	352-357	USR Wall Box
127-132	HL Near Box Boom	358-363	Orchestra Pit
133-138	SL Drop Cable A - 1 <sup>st</sup> Electric	364-369	SL Drop Cable - DS Orchestra Shell
139-144	SL Drop Cable B - 1 <sup>st</sup> Electric	370-375	SL Drop Cable - MS Orchestra Shell
145-150	SL Drop Cable C - 1 <sup>st</sup> Electric	376-381	SL Drop Cable - US Orchestra Shell
151-156	SL Drop Cable D - 1 <sup>st</sup> Electric	382	Non-Dim Spot Booth
157-162	SL Drop Cable E - 1 <sup>st</sup> Electric	383	Non-Dim FOH 1 Catwalk HR
163-168	SL Drop Cable F - 1A Electric	384	Non-Dim FOH 1 Catwalk HL
169-174	SL Drop Cable G - 2 <sup>nd</sup> Electric	385	Non-Dim FOH 2 Catwalk HR
175-180	SL Drop Cable H - 2 <sup>nd</sup> Electric	386	Non-Dim FOH 2 Catwalk HL
181-186	SL Drop Cable I - 2 <sup>nd</sup> Electric	387	Non-Dim Balcony Rail
187-192	SL Drop Cable J - 2 <sup>nd</sup> Electric	388	Non-Dim Balcony Rail
193-198	SL Drop Cable K - 2 <sup>nd</sup> Electric	389	Non-Dim HR Far Box Boom
199-204	SL Drop Cable L - 3 <sup>rd</sup> Electric	390	Non-Dim HL Far Box Boom
205-210	SL Drop Cable M - 3 <sup>rd</sup> Electric	391	Non-Dim HR Near Box Boom
211-216	SL Drop Cable N - 3 <sup>rd</sup> Electric	392	Non-Dim HL Near Box Boom
217-222	SL Drop Cable O - 3 <sup>rd</sup> Electric	393	SL Drop Cable Non-Dim
223-228	SL Drop Cable P - 3 <sup>rd</sup> Electric	394	SL Drop Cable Non-Dim
229-234	SL Drop Cable Q - 3A Electric	395	SL Drop Cable Non-Dim
235-240	SL Drop Cable R - 4 <sup>th</sup> Electric	396	SL Drop Cable Non-Dim
241-246	SL Drop Cable S - 4 <sup>th</sup> Electric	397	SL Drop Cable Non-Dim
247-252	SL Drop Cable T - 4 <sup>th</sup> Electric	398	SL Drop Cable Non-Dim
253-258	SL Drop Cable U - 4 <sup>th</sup> Electric	399	Non-Dim SL Pin Rail
259-264	SL Drop Cable V - 5A Electric	400	Non-Dim SR Pin Rail
265-270	SL Drop Cable W - 5 <sup>th</sup> Electric	401	Non-Dim DSL Box
271-276	SL Drop Cable X - 5 <sup>th</sup> Electric	402	Non-Dim DSR Box
277-282	SL Drop Cable Y - 5 <sup>th</sup> Electric	403	Non-Dim USL Box
283-288	SL Drop Cable Z - Spare	404	Non-Dim USR Box
289-294	SL Drop Cable AA - Spare	405	Non-Dim Orchestra Pit
295	SL Drop Cable BB - 60A		

**LINESET SCHEDULE**

<b>LS#</b>	<b>Dist</b>	<b>Item</b>	<b>Status</b>	<b>Wt (# Bricks)</b>	<b># of Circuits</b>	<b>Dim #</b>
1	1' 6"	Main Drape	Permanent/Unavailable	12		
2	2' 6"	#1 Border		3		
3	3' 0"	Movie Screen	Permanent/Unavailable	8.5		
4	3' 6"	#1 Legs		2		
5	4' 6"	#1 Electric		18	30	133-162
6	5' 6"					
7	6' 6"	Orchestra Shell	Permanent/Unavailable	38	6	364-369
8	7' 6"	#1 Strip Lights		9.5	6	163-168
9	8' 6"					
10	9' 6"					
11	10' 6"	#2 Border		3		
12	11' 0"	#2 Legs		2		
13	12' 0"	#2 Electric		17.5	30	169-198
14	13' 0"	MS Choral Mics				
15	14' 0"					
16	15' 0"					
17	16' 0"	Orchestra Shell	Permanent/Unavailable	35.5	6	370-375
18	17' 0"	#3 Border		3		
19	18' 0"	#3 Legs		2		
20	19' 0"	#3 Electric		10	30	199-228
21	20' 6"	#2 Strip Lights		10	6	229-234
22	21' 6"	White Scrim		1.5		
23	22' 0"	Black Traveller		12		
24	23' 0"					
25	24' 0"	US Choral Mics				
26	25' 0"	#4 Border		3		
27	26' 0"	Orchestra Shell	Permanent/Unavailable	32.5	6	376-381
28	27' 0"	#4 Legs		2		
29	28' 0"	#4 Electric		13.5	24	235-258
30	29' 0"	#3 Strip Lights		10	6	259-264
31	30' 0"	#5 Border		3		
32	31' 0"	#5 Legs		2		
33	31' 6"	Black Scrim		2		
34	32' 6"	#5 Electric (Cyc Lights)		10.5	18	265-284
35	33' 6"					
36	34' 6"	White Cyc		3		
37	35' 0"	Star Curtain		6	1	288
38		SR Side Tabs	Permanent/Unavailable			
39		SL Side Tabs	Permanent/Unavailable			

